



DEAN CALLAN

& COMPANY INC

BRIT BANKS

Senior Broker Associate

Direct: 303.945.2020

Cell: 303.903.9775

bbanks@deancallan.com

TORREY PATTERSON

Broker Associate

Direct: 720.826.2291

Cell: 303.514.4559

tpatterson@deancallan.com

DEAN CALLAN & COMPANY, INC.

1510 28th Street, Suite 200

Boulder, Colorado 80303

303.449.1420 | www.deancallan.com

INDUSTRIAL SPACE FOR LEASE

**WASHINGTON COMMERCE CENTER
525-665 EAST 70TH AVENUE
DENVER, COLORADO 80229**

Exceptional industrial spaces await at Washington Commerce Center. Each unit strikes the perfect balance between office and warehouse space, complete with private restrooms. Enjoy the impressive frontage appeal, offering high visibility from both Washington Street and East 70th Avenue. The strategic location ensures tenants seamless access to Denver's major arteries.

[Call us for more information and to set up a tour.](#)

TERMS

1	Unit 525-1W:	2,000 SF \$2,700/MO
2	Unit 565-4W:	1,800 SF \$2,430/MO

PROPERTY FEATURES

- Prime office/warehouse spaces
- Excellent highway access and highway visibility
- Sprinklered space available (605 and 625 Buildings)
- Ample 3 phase power
- Varying amount of office space in each unit
- Insulated roof deck
- Skylights
- All units have drive-in overhead doors
- 16' clear-height

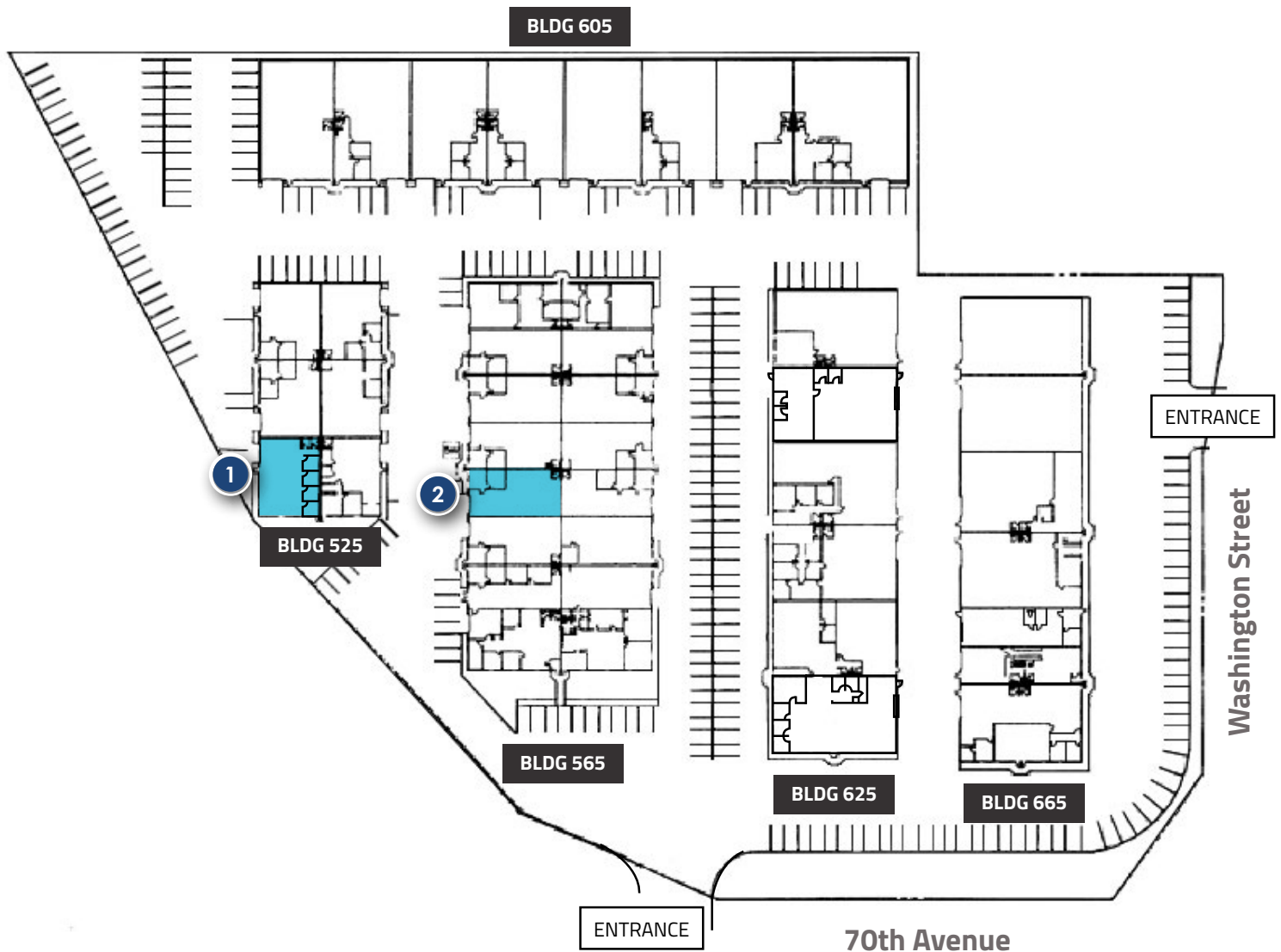

All information furnished regarding this property is obtained from sources deemed reliable. Dean Callan & Company, Inc. makes no representation, guarantee or warranty, expressed or implied, as to the accuracy thereof.



DEAN CALLAN
& COMPANY INC

BRIT BANKS
Senior Broker Associate
Direct: 303.945.2020
Cell: 303.903.9775
bbanks@deancallan.com

TORREY PATTERSON
Broker Associate
Direct: 720.826.2291
Cell: 303.514.4559
tpatterson@deancallan.com

DEAN CALLAN & COMPANY, INC.
1510 28th Street, Suite 200
Boulder, Colorado 80303
303.449.1420 | www.deancallan.com



All information furnished regarding this property is obtained from sources deemed reliable. Dean Callan & Company, Inc. makes no representation, guarantee or warranty, expressed or implied, as to the accuracy thereof.